

REVISIONS				
ZONE	REV	DESCRIPTION	DATE	APPROVED
-	A	CREATE DRAWING, ECO#1701	03/17/10	JRJ
-	B	CHANGE STACK UP, ECO#2238	08/10/15	JRJ

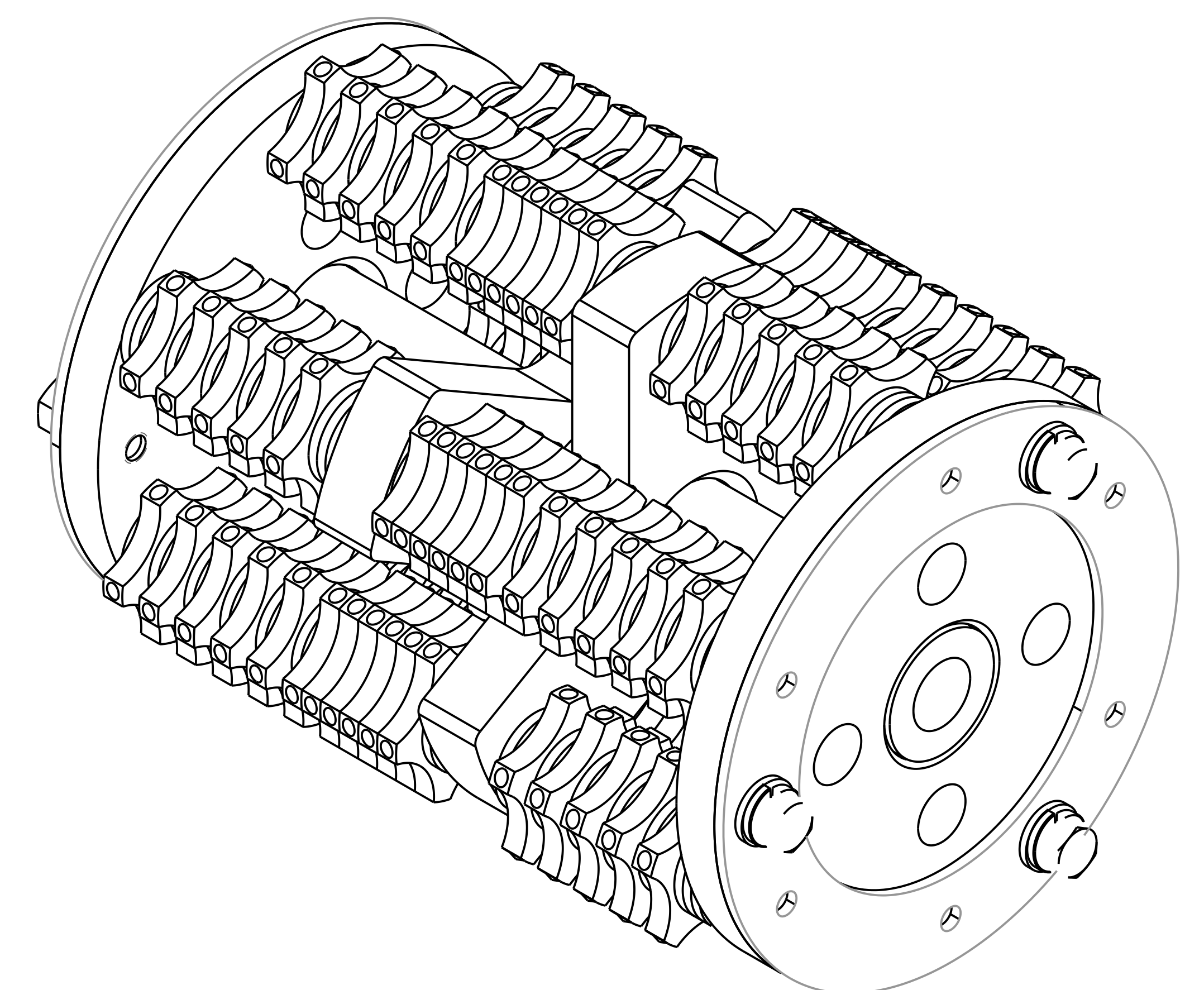
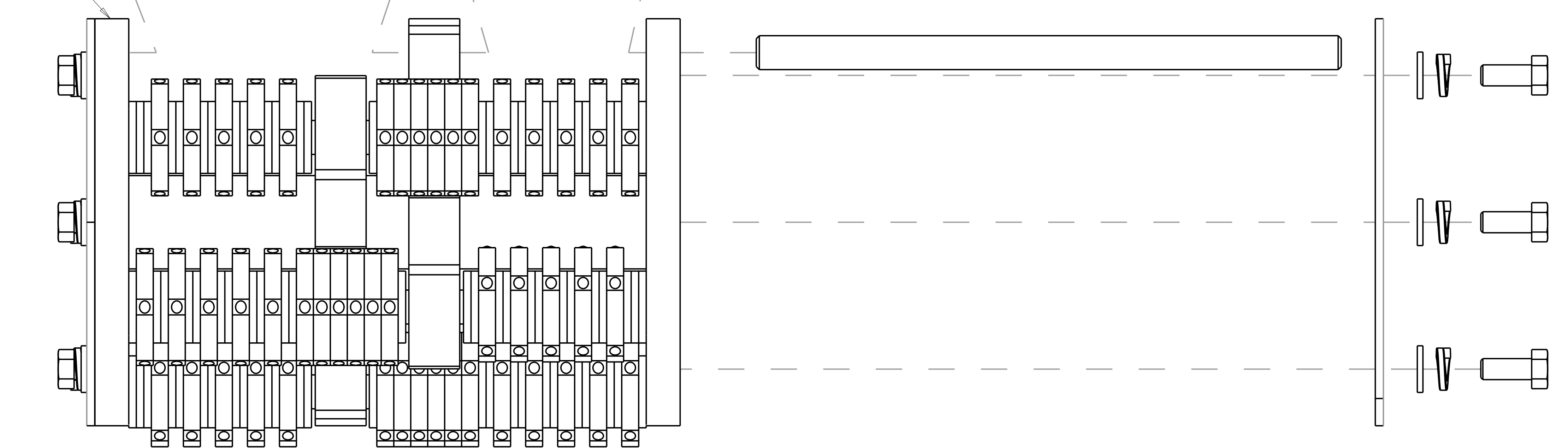
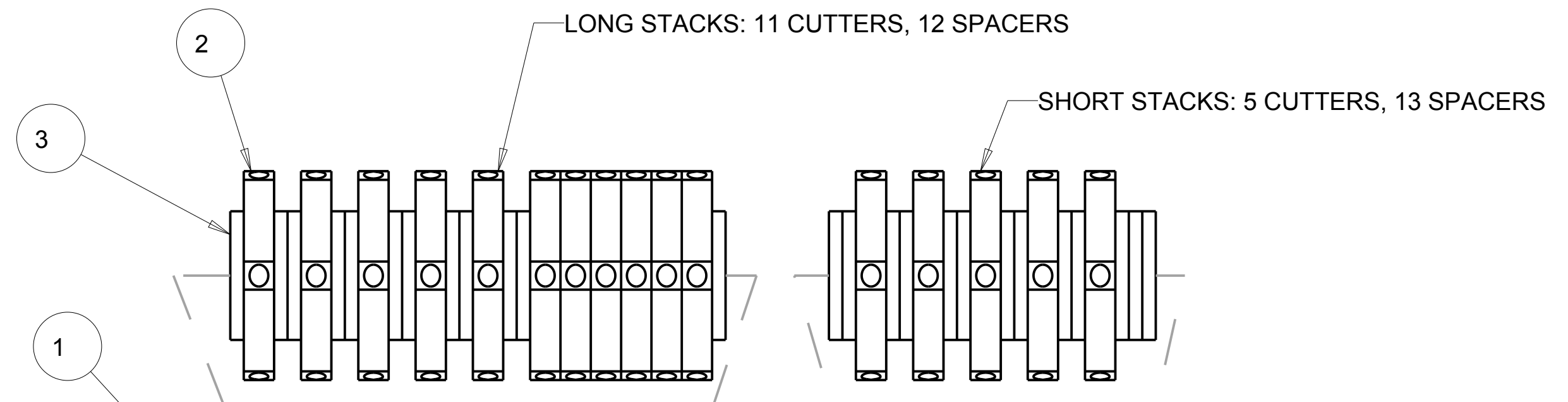

QTY. REQ.	PART OR IDENTIFYING NO.	DESCRIPTION	ITEM NO.
150	158575	SPACER, 1/2 HARDENED STEEL	3
96	158492	CUTTER, 5 POINT CARBIDE	2
1	158460	ASSY, SCARIFIER DRUM	1

PARTS LIST			
TOLERANCES UNLESS OTHERWISE SPECIFIED	DRAWN	JRJ	DATE
DIMENSIONS ARE IN INCHES	CHECK	SMH	03/17/10
WHOLE NO. AND FRACTIONS = 1/16 (EXCEPT DRILL HOLES)	DESIGN	-	03/17/10
X = ±.03	NEXT ASSY.		
XX = ±.010	-		
XXX = ±.005	PROPRIETARY NOTICE: THIS DRAWING AND INFORMATION IT CONTAINS ARE THE PROPERTY OF MK DIAMOND INC. AND ARE CONSIDERED CONFIDENTIAL AND MAY NOT BE REPRODUCED, COPIED, OR USED IN PART OR IN WHOLE WITHOUT THE WRITTEN CONSENT OF MK DIAMOND PRODUCTS INC.		
ANGLES = ±1/2°	SIZE	D	REV
DO NOT SCALE DRAWING	APPLICATION	SCALE: 1:000	B

MK DIAMOND PRODUCTS INC.
1315 STORM PARKWAY
TORRANCE, CA. 90509

MK-SG SCARIFIER ASSY, DRUM, 96X5 POINT CARBIDE

SIZE: **D** PART NO. **158583** DWG. NO. **158583**

1
2
3
4
5