

7" Dust Shroud

INSTRUCTION SHEET



1. Place grinder on the floor, face up. (Blastrac and Bosch model grinders 1873-6, 1873-8, 1893-6, and 1894-6 do not require a spacer. Please skip to Step 4)



2. Select appropriate spacer for your model grinder chart:

MAKE	MODEL	SPACER PART#
Metabo	W23-180	165987
Milwaukee	6088-20	165986
Hitachi	G18MR	165985
DeWalt*	D28493	165983
Makita	GA7020	165982
Jepson*	4207N	165983



3. Place spacer over grinder head with the Exterior Groove **(A)** facing down, toward the grinder head. Push down until Interior O-ring **(B)** snaps into place.

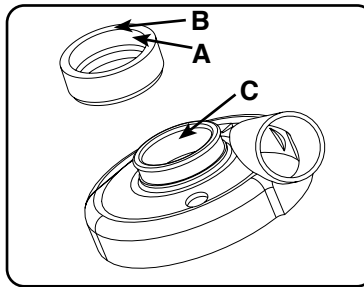

- A. Spacer Exterior Groove
- B. Spacer Interior O-ring
- C. Shroud Interior O-ring



4. Take shroud clamp and place on the top of the shroud loosely.



5. Place shroud on grinder, push and twist until Shroud Interior O-ring **(C)** snaps into Spacer Exterior Groove **(A)**. (For Bosch model grinders, Shroud Interior O-ring **(C)** snaps directly onto grinder head.)



6. Tighten clamp with wing nut so it is firmly attached to grinder head.

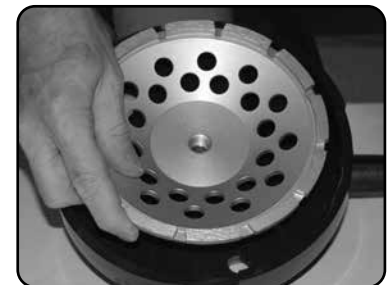

7. Once shroud is tightly attached to the grinder, attach grinding wheel as normal. Ensure cup wheel does not contact shroud.

7" Dust Shroud

INSTRUCTION SHEET

Hinged Nose Instructions



1. Lift nose of shroud.



2. Place against wall and grind.

OPTIONAL ACCESSORY: CUP WHEEL ADAPTER (Part# 167149)

Cup Wheel Adapter For Use With Arbor Cup Wheels



1. Screw cup nut on grinder arbor shaft.



2. Place washer on top of cup nut, if needed.



3. Place cup wheel on washer.



4. Screw hex nut onto cup nut.

Cup Wheel Adapter (sold separately)

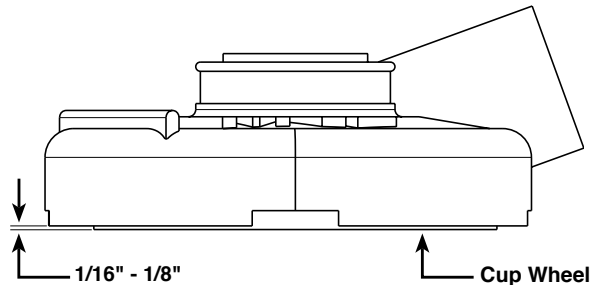
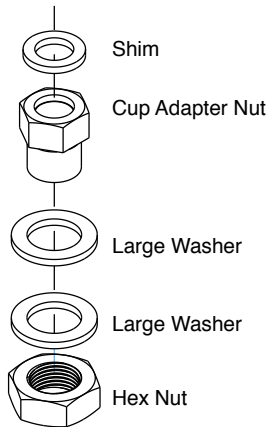

Shim is for use with a DeWalt or Jepsen grinder, or as cup wheel is worn, it may be used to achieve distance if needed.

If necessary place large washer(s) on cup adapter nut, so cup wheel extends 1/6" to 1/8" beyond shroud.



Silica Dust Warning

Grinding/cutting/drilling of masonry, concrete, metal and other materials can generate dust, mists and fumes containing chemicals known to cause serious fatal injury or illness, such as respiratory disease, cancer, birth defects or other reproductive harm. If you are familiar with the risks associated with the particular material being cut, review the material safety data sheet and/or consult your employer, the material manufacturer/supplier, governmental agencies such as OSHA and NIOSH and other sources of hazardous materials. California and some other authorities, for instance, have published lists of substances known to cause cancer, reproductive toxicity, or other harmful effects. Control dust, mist and fumes at the source where possible. In this regard use good work practices and follow the recommendations of the manufacturer/supplier, OSHA/NIOSH, and occupational and trade associations. When the hazards from inhalation of dust, mists and fumes cannot be eliminated, the operator and any bystanders should always wear a respirator approved by OSHA/MSHA for the material being cut. For more information go to www.P65warnings.ca.gov.