

NOTES:
1. WIRING DIAGRAM AVAILABLE ON DRAWING 172662.

MACHINING DETAIL

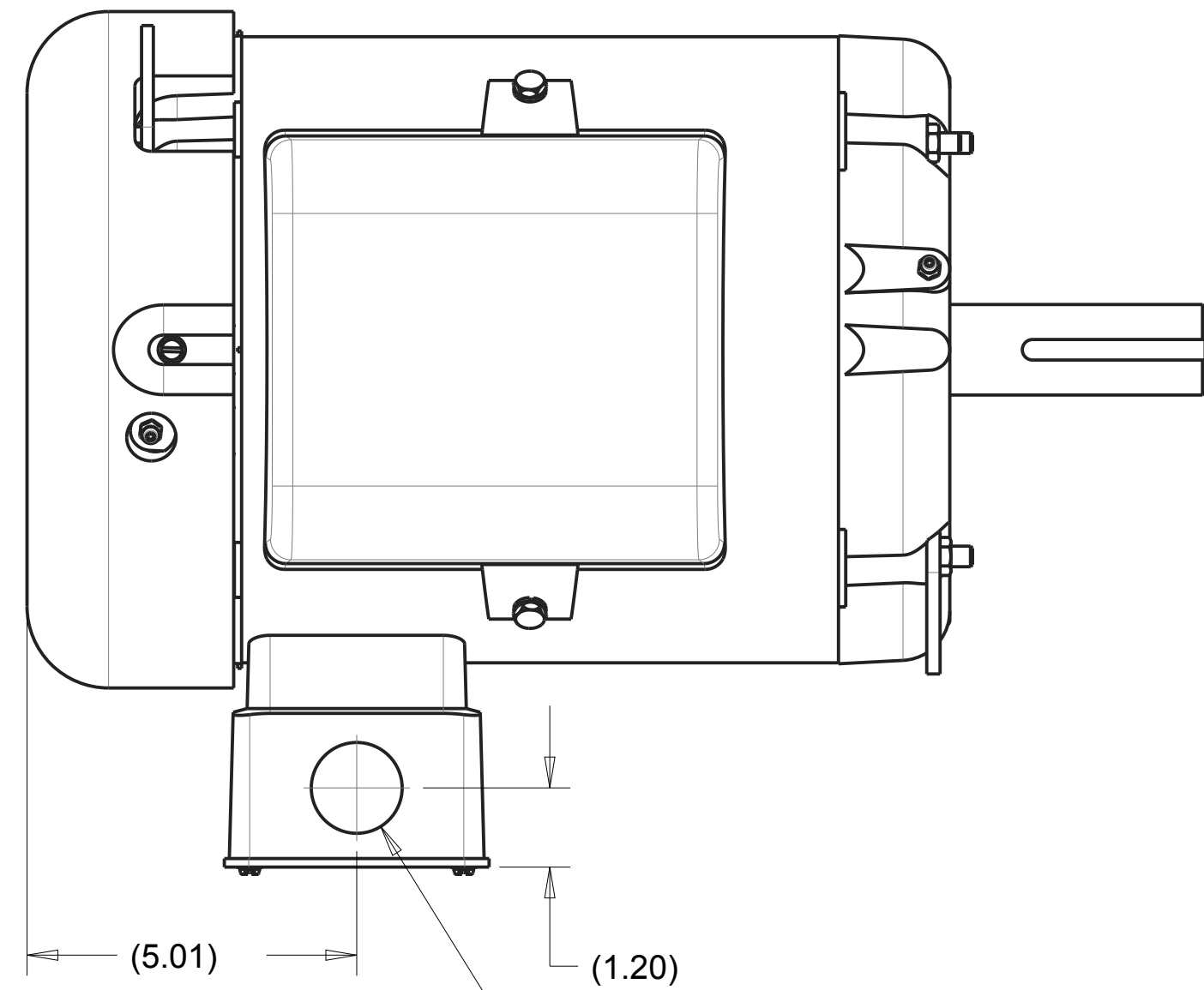

MOTOR ARRIVES WITH (Ø 1.38).
ORIENT BOX AS SHOWN BEFORE MACHINING/ASSEMBLING.

DRILL Ø 1-1/16 (1.063) THRU ONE WALL

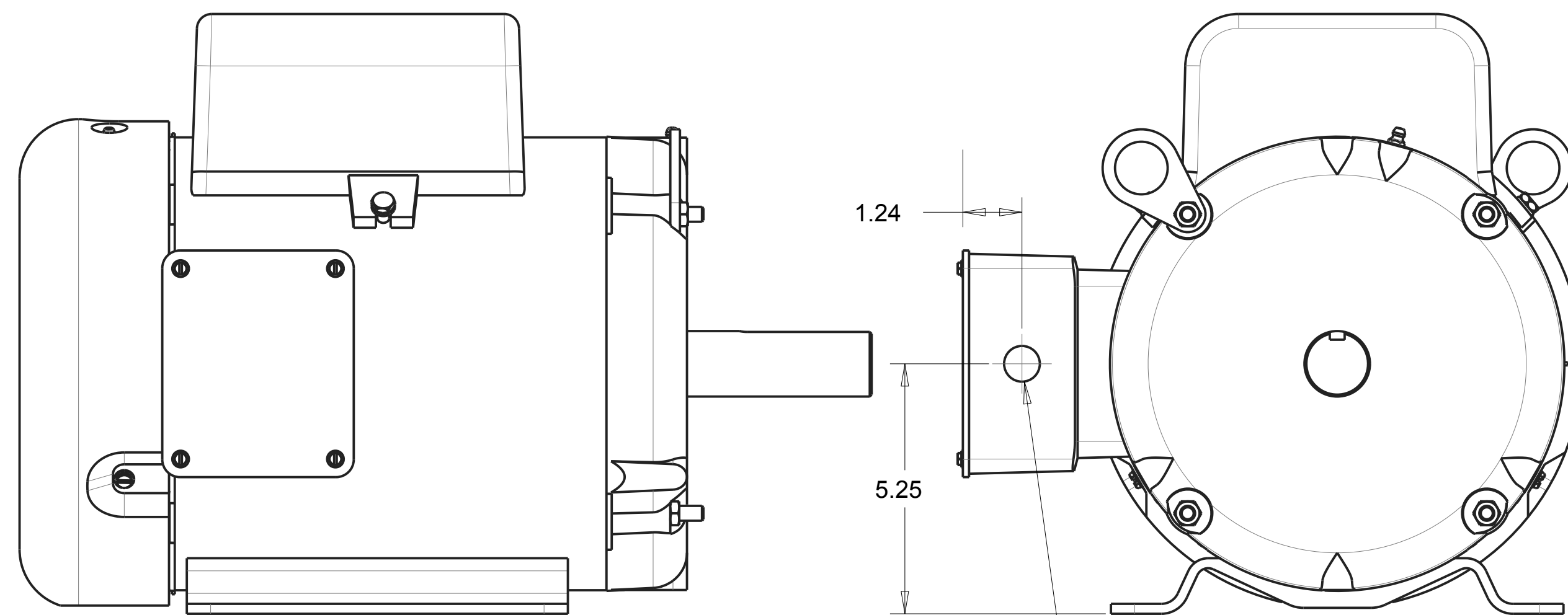
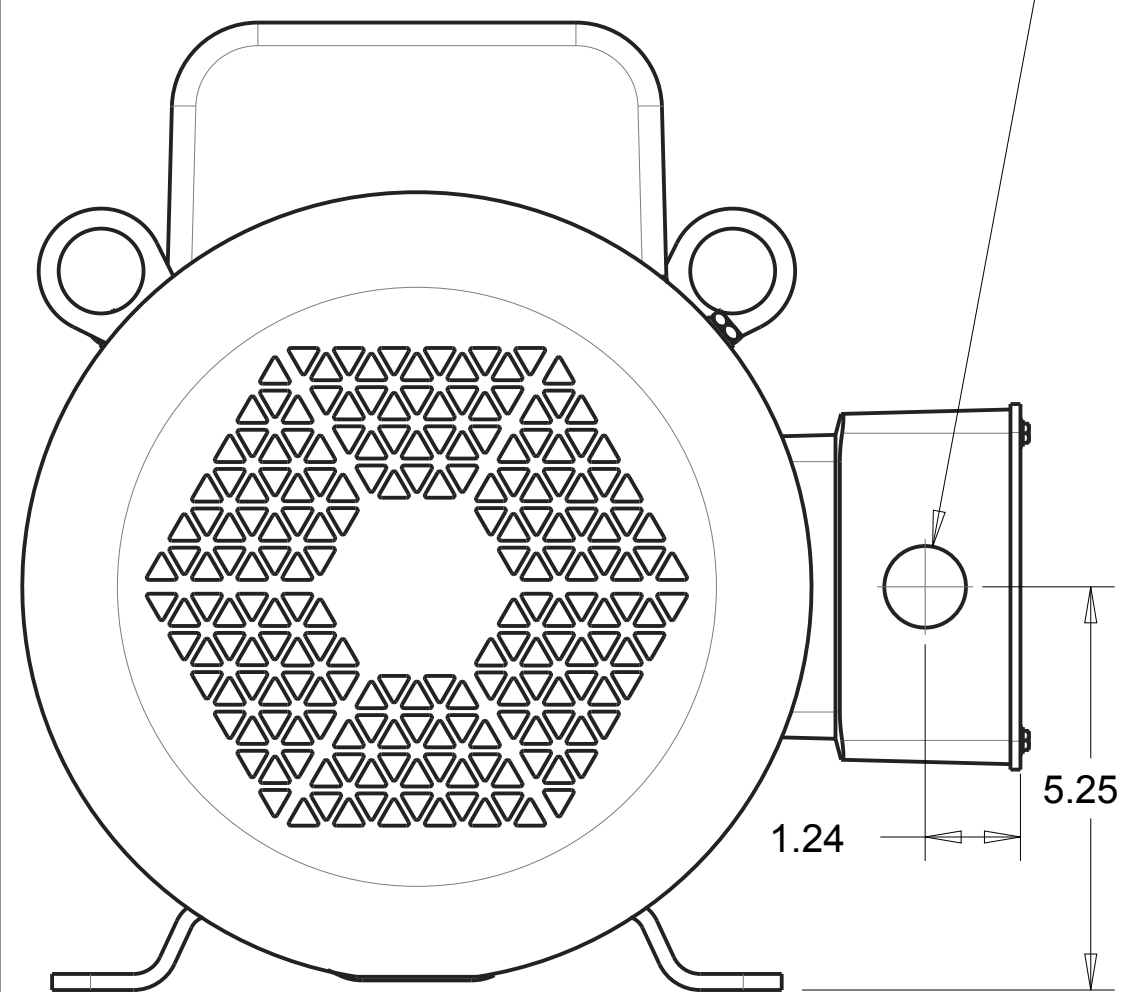

DRILL Ø 3/4 (.750) THRU ONE WALL

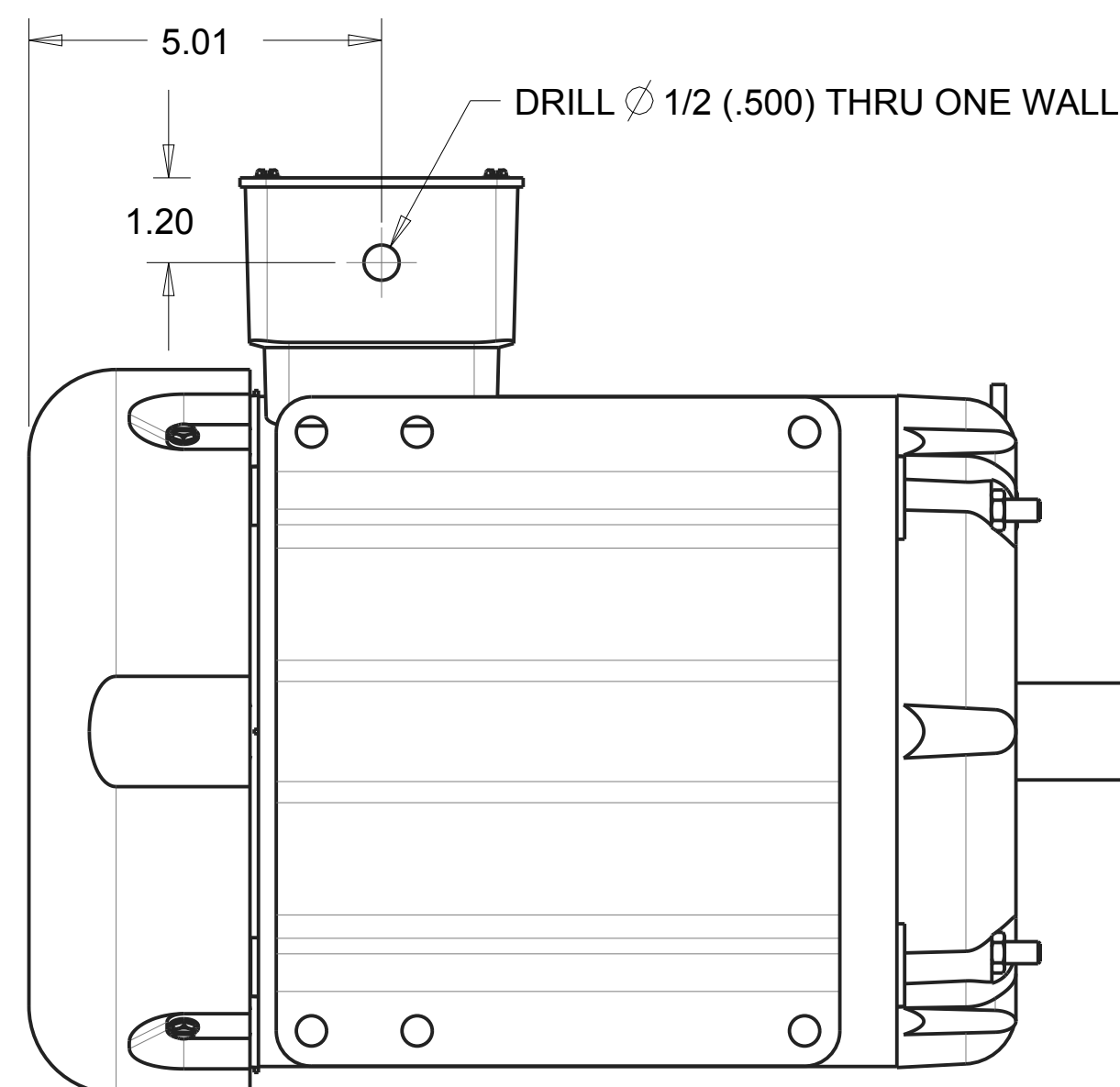

DRILL Ø 1/2 (.500) THRU ONE WALL

REVISIONS				
ZONE	REV	DESCRIPTION	DATE	APPROVED
-	-	INITIAL RELEASE, ECO# 2390	10/15/18	SSH
-	A	UPDATE METHOD AND BOM, ECO# 2479	03/31/20	SSH

BOM DETAIL

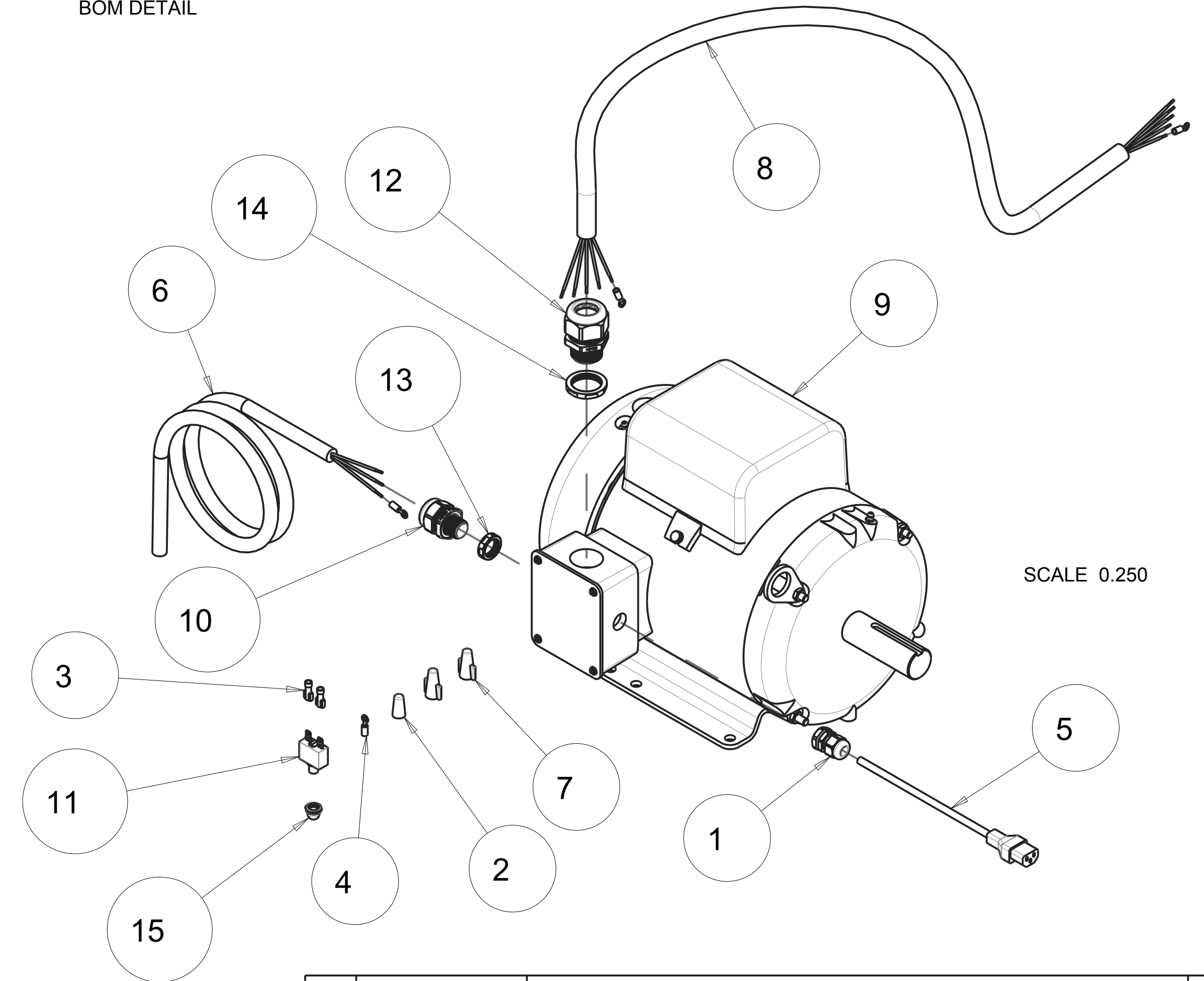

SCALE 0.250

QTY. REQ.	PART OR IDENTIFYING NO.	DESCRIPTION	ITEM NO.
1	172910	BOOT, THERMAL SWITCH, M11	15
1	172898	NUT, STRN RLF, PLAS, 1NPT	14
1	172886	NUT, STRN RLF, PLAS, 3/4NPT	13
1	172843	CONNECTOR, CORD, LTF1	12
1	172780	SWITCH, THERMAL 20A	11
1	172738	CONNECTOR, CORD, LTF 3/4	10
1	172660	MTR, 5HP 220V 50HZ 1PH 1450RPM, L3708T-50	9
1	172548_01	CORD, ELEC, 10/5 SOOW BLACK (4.5 FT)	8
2	172202	WIRE NUT, 4#10 (RED)	7
1	171227_06	CORD, ELEC, 10/3 SJOOW, BLACK (6 FT.)	6
1	166279	CORD, 9', W/IEC60320 FEM	5
4	165108	TERMINAL, 12-10 X #10 RING PI	4
2	161297	TERMINAL, 12-10 X .25 QD F FI	3
1	159968	WIRE NUT 4#16 (YELLOW)	2
1	159582	CONNECTOR, CORD, LTF11	1

PARTS LIST			
TOLERANCES UNLESS OTHERWISE SPECIFIED	DATE		
DRAWN	SSH	10/15/18	
CHECK	XXX	XXXX/XX/XX	
DESIGN	SSH	10/15/18	
NEXT ASSY.			
-			
<p>PROPRIETARY NOTICE: THIS DRAWING AND INFORMATION IT CONTAINS ARE THE PROPERTY OF MK DIAMOND INC. AND ARE CONSIDERED CONFIDENTIAL AND MAY NOT BE REPRODUCED, COPIED, OR USED IN PART OR IN WHOLE WITHOUT THE WRITTEN CONSENT OF MK DIAMOND PRODUCTS INC.</p>			
SIZE	PART NO.	DWG. NO.	REV.
D	172661	172661	A
DO NOT SCALE DRAWING		APPLICATION	SHEET: 1 of 1

MK MK DIAMOND PRODUCTS INC.
1315 STORM PARKWAY
TORRANCE, CA. 90509

MK-5005S BLK SAW
MTR, 5HP 220V/50HZ 1PH 1450RPM, L3708T-50 COMP

SCALE: 0.400